



i3HAWM (HEIGHT ADJUSTABLE WALL MOUNT)

Electronic

move your interactive whiteboard up or down by 50 cm (20") with the i3HAWM wall mount. It's easy and works with any interactive whiteboard system - you can even make the height adjustment with one hand. The wall mount is easy to install and locks at it's highest point so that students at the back of the class can always see the board. The fully integrated electronic system provides stability for the projector.

Anti-collision protection

The standard anti-collision protection is triggered by a minimal counter pressure, stops the engine, and retracts 2 cm (0.7").

Option

Drywall kit (for weak walls)

ADA sensitive

With a height range up to 36" users of all ages, heights and abilities can approach and control the board comfortably and ergonomically. With the touch of a button the i3HAWM adjusts. The board and projector move simultaneously, touch maintaining calibration and picture clarity. The simplistic and intuitive design makes the i3HAWM a perfect solution for special needs students and classrooms. Wheelchairs fit comfortably underneath the board to increase forward reach, in addition the greater range of adjustment allows users to lower the board only inches off the ground increasing side reach.



Projector moves with the board to maintain calibration.



Straightforward adjustment buttons



MDF board for universal projector mounting

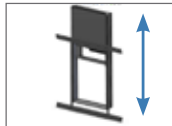

Adjustable mounting rails



Adjustment range	53.3 cm (20.9")
Weight	44.4 kg
Maximum weight	1200 N (120 lbs.)
Dimensions	158 x 65,5 x 16 cm
Package dimensions	170 x 72 x 20 cm
Warranty	2 years

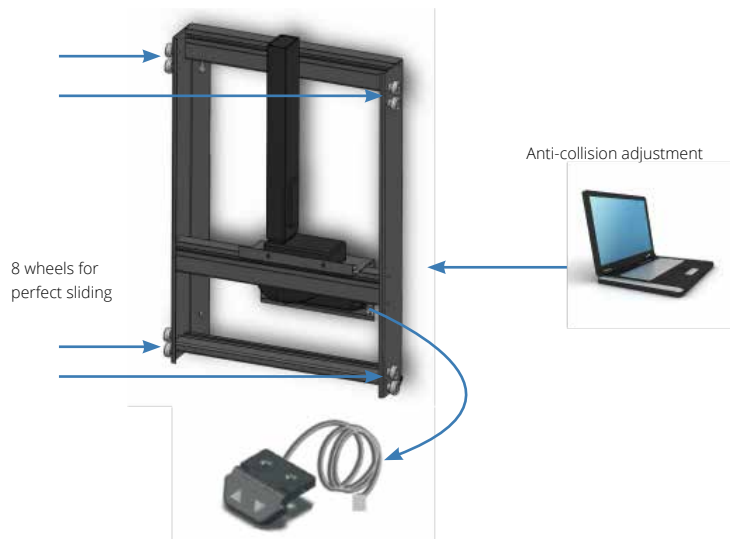

AUTHORISED DISTRIBUTOR